



OAKFIELD



Campbell Close, Uckfield, TN22 1DR

£1,150 Per Calendar Month



Campbell Close, Uckfield, TN22 1DR

This two bedroom ground floor flat is not one to be missed and is ready to move into now.

Benefiting from its own private entrance this property has been recently renovated throughout. The modern newly fitted kitchen includes a bosch undercounter double oven with electric hob and extractor fan. There is space for a fridge/freezer as well as space with plumbing for a washing machine. There is a spacious living room as well as two bedrooms, bedroom one is a double and bedroom two a single. The newly fitted bathroom is a modern white suite with shower over the bath.

Accessible to the side of the property is a private rear garden with shed storage, there is ample on street parking and electric heating throughout.

Please Note:
An annual household income of £31,500 is required to meet the affordability criteria for this property.
The tenancy will begin with a 12 month initial term.





Entrance Hall

18'11" x 2'09" (5.77m x 0.84m)

Bedroom one

12'7" x 8'5" (3.86m x 2.58m)

Bedroom two

8'8" x 8'5" (2.66m x 2.58m)

Bathroom

6'8" x 5'8" (2.04m x 1.73m)

Living room

13'6" x 12'7" (4.14m x 3.85m)

Kitchen

13'3" x 8'7" (4.04m x 2.63m)

Garden

Council Tax Band B - £2,090.58 Per Annum



Floor Plan

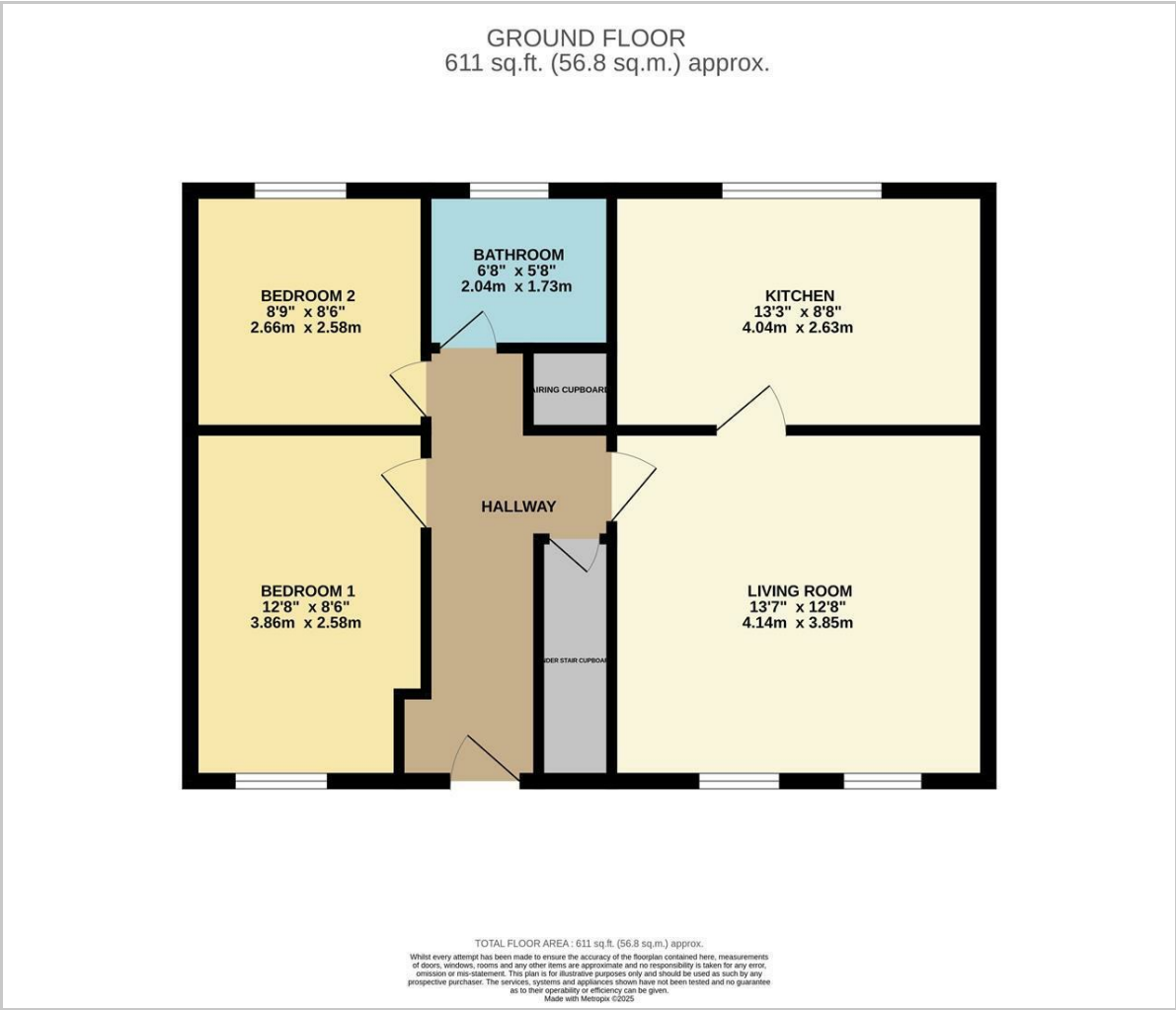

Viewing

Please contact us on 01825 729673
if you wish to arrange a viewing appointment for this property or require further information.

These particulars, whilst believed to be accurate are set out as a general outline only for guidance and do not constitute any part of an offer or contract. Intending purchasers should not rely on them as statements of representation of fact, but must satisfy themselves by inspection or otherwise as to their accuracy. No person in this firms employment has the authority to make or give any representation or warranty in respect of the property.

Area Map

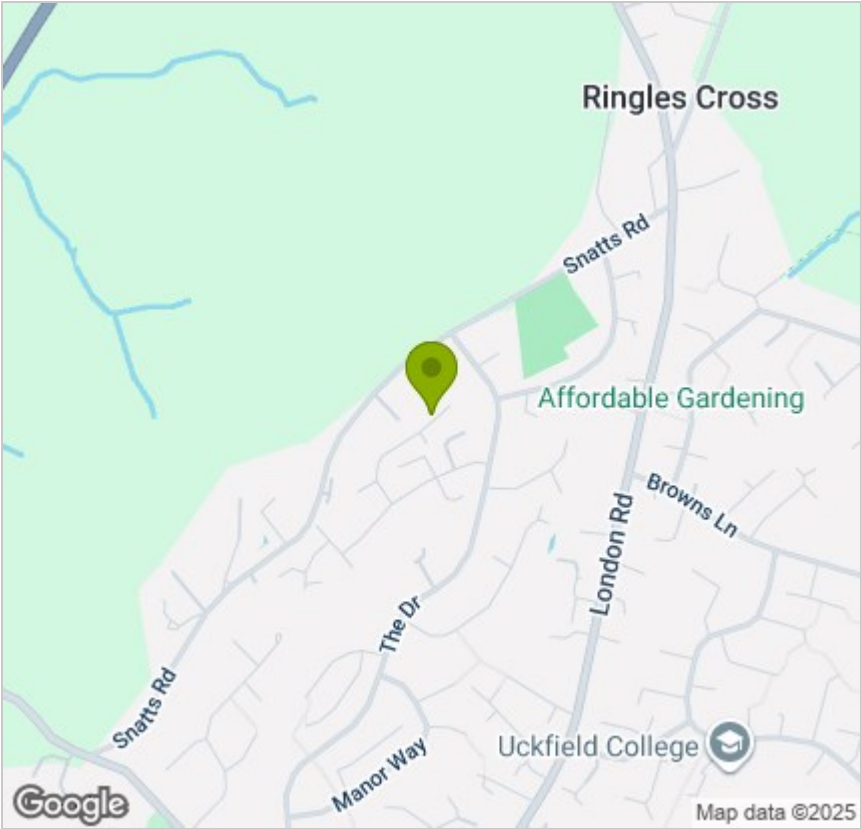

Energy Efficiency Graph

